

# GEORGE WRIGHT AIR FORCE BASE

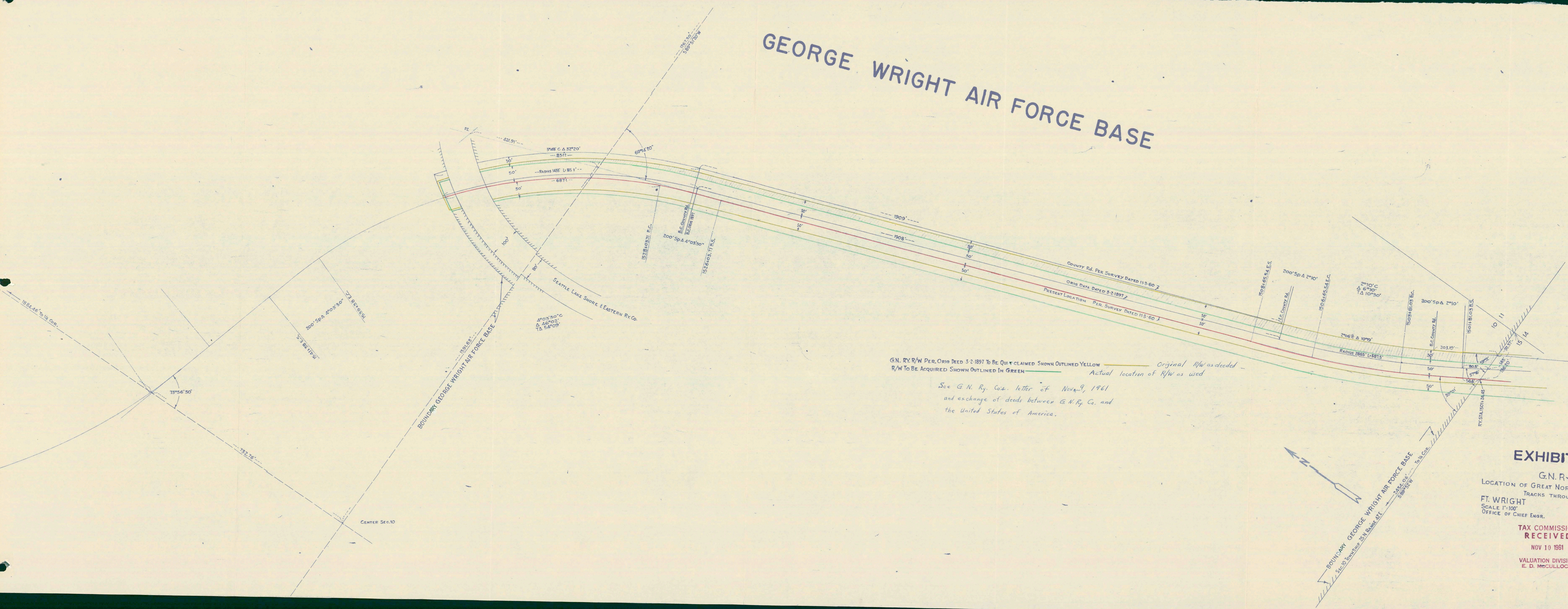

G.N. RY. R/W PER ORIG DEED 3-2-1897 TO BE QUIT CLAIMED SHOWN OUTLINED YELLOW ——— Original R/W as deeded  
 R/W TO BE ACQUIRED SHOWN OUTLINED IN GREEN ——— Actual location of R/W as used

*See G. N. Ry. Co. letter of Nov. 9, 1961  
 and exchange of deeds between G. N. Ry. Co. and  
 the United States of America.*

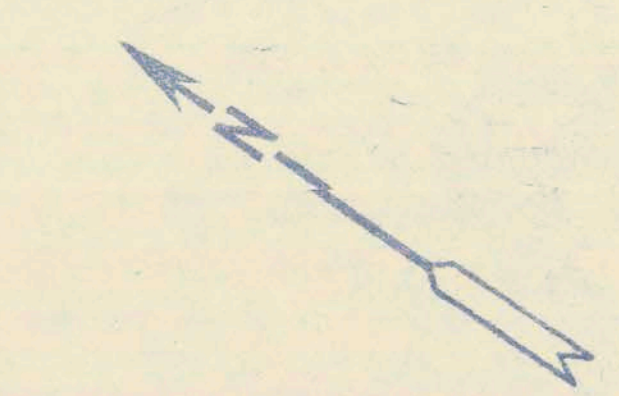

62-1A

## EXHIBIT "A"

G.N. RY.  
 LOCATION OF GREAT NORTHERN RY. CO.  
 TRACKS THROUGH  
 FT. WRIGHT  
 SCALE 1"=100'  
 OFFICE OF CHIEF ENGR.

WASH.  
 Nov. 15, 1960.  
 ST. PAUL, MINN.

TAX COMMISSION  
 RECEIVED  
 NOV 10 1961

VALUATION DIVISION  
 E. D. McCULLOCH