

PUGET SOUND POWER & LIGHT CO.
 and STANDARD OIL CO. SPUR
 L.D. Cont. No. 25642 Sept. 10, 1931.
 R.R. to City, Ry. to own and maintain.
 City to Ry. to maintain at expense
 of Ind. Ry. to own.

THE TEXAS CO. SPUR
 L.D. Cont. No. 25655 Oct. 23, 1930.
 Ry. Co. to own and maintain. (5194')

TRUE'S OIL CO. EXTENSION
 L.D. Cont. No. 25655 Oct. 23, 1930.
 Ry. Co. to own and maintain. (5194')

L. D. Cont. No. 25433 Apr. 15, 1931
 G. N. Ry. grants Wash. Elec. Co. right to inundate
 Ry. right of way and to raise the waters of the Wenatchee
 and Columbia Rivers from Rock Island Dam to
 Zena, not to exceed 60 feet above sea level at dam
 site. Elec. Co. to provide new roadbed, Sta. 8852 to
 8963. Ry. Co. to move tracks and facilities to new
 roadbed at expense of Elec. Co. Wash. Elec. Co. transfers
 all rights to P.S.P. & L. Co. June 1931. (See Chief Engr. Gen. File M100-31)

L. D. Cont. No. 18964 Oct. 5, 1923
 Ry. grants Wash. Coast Utilities (now P.S.P. & L. Co.)
 right to construct and maintain gas mains under and
 electric transmission lines over Ry. Co. R.F.W. of
 Spokane and Chelan Sts., also vacated portion
 of Spokane St. Ry. Co. has right to grant easement
 across Thurston St. in lieu of easement across
 Spokane St.

Match Mark Line for Street No. 2

All in CA - 1
 "Wenatchee"

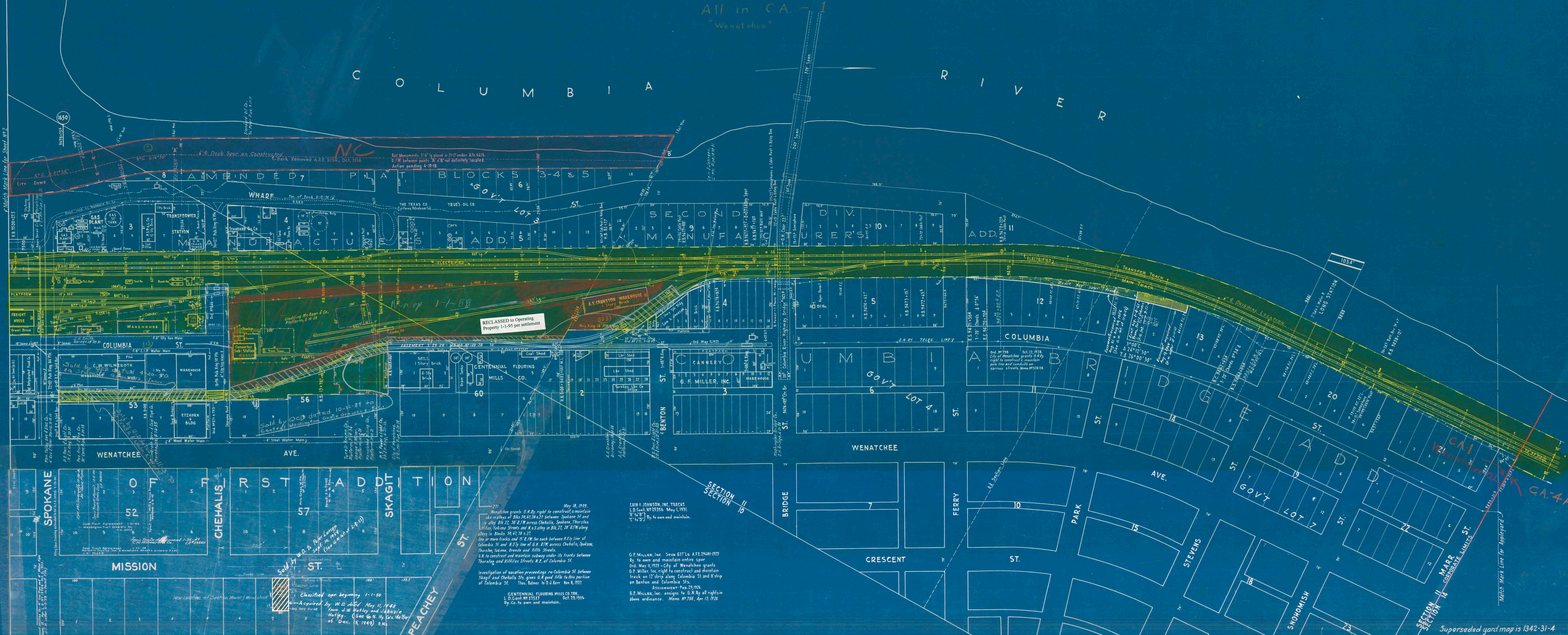

RECLASSIFIED to Operating
 Property 1-1-95 per settlement.

Wenatchee grants G.N.Ry. right to construct/maintain
 also in all of Blks 50, 42, 28 & 17 between Spokane St. and
 in alley Blk 22, 30 R.W. across Chehalis, Spokane, Thurston
 streets, Yakima Street and R.W. City on Blk. 22, 27 R.W. along
 alley in Blks 50, 42, 28 & 17.
 Also in more tracks and R.W. for each between R.W. line of
 Columbia St. and R.W. line of G.N. Ry. across Chehalis, Spokane,
 Thurston, Yakima, Grand and Fifth Streets.
 G.N. to construct and maintain subway under its tracks between
 Thurston and Killian Streets N.E. of Columbia St.

Investigation of vacation proceedings re Columbia St. between
 Skagit and Chehalis Sts. given R.W. good title to this portion
 of Columbia St. This volume to D.D. Kerr Nov. 8, 1927.

CENTENNIAL FLOURING MILLS CO. TRK.
 L.D. Cont. No. 27557 Oct. 23, 1930.
 Ry. Co. to own and maintain.

CAN & JOHNSON, INC. TRACKS
 L.D. Cont. No. 93356 May 1, 1931.
 Ry. Co. to own and maintain.

G.F. MILLER, Inc. Open 677' x 336' 71/2" 1908-1925
 Ry. to own and maintain entire spur.
 Oct. 11, 1925 - City of Wenatchee grants
 G.F. Miller, Inc. right to construct and maintain
 track on 12' strip along Columbia St. and 8' strip
 on Benton and Columbia Sts.

Assignment - Feb. 25, 1926.
 G.F. Miller, Inc. assigns to G.N. Ry. all rights
 above ordinance. Memo #785, Apr. 13, 1926.

67-19E

GREAT NORTHERN RAILWAY
 WILSON CREEK - PESHASTIN SECT.
WENATCHEE NO.
 CHELAN CO. WASH.
 SEC'S. 10 & 11, T. 22 N., R. 20
 SCALE 1 IN. = 100 FT. MAP APPR.
 P.W. Map R 803-4, Prof. 803-4 Revised Jan.

Superseded yard map is 1342-31-4

2-14-2